

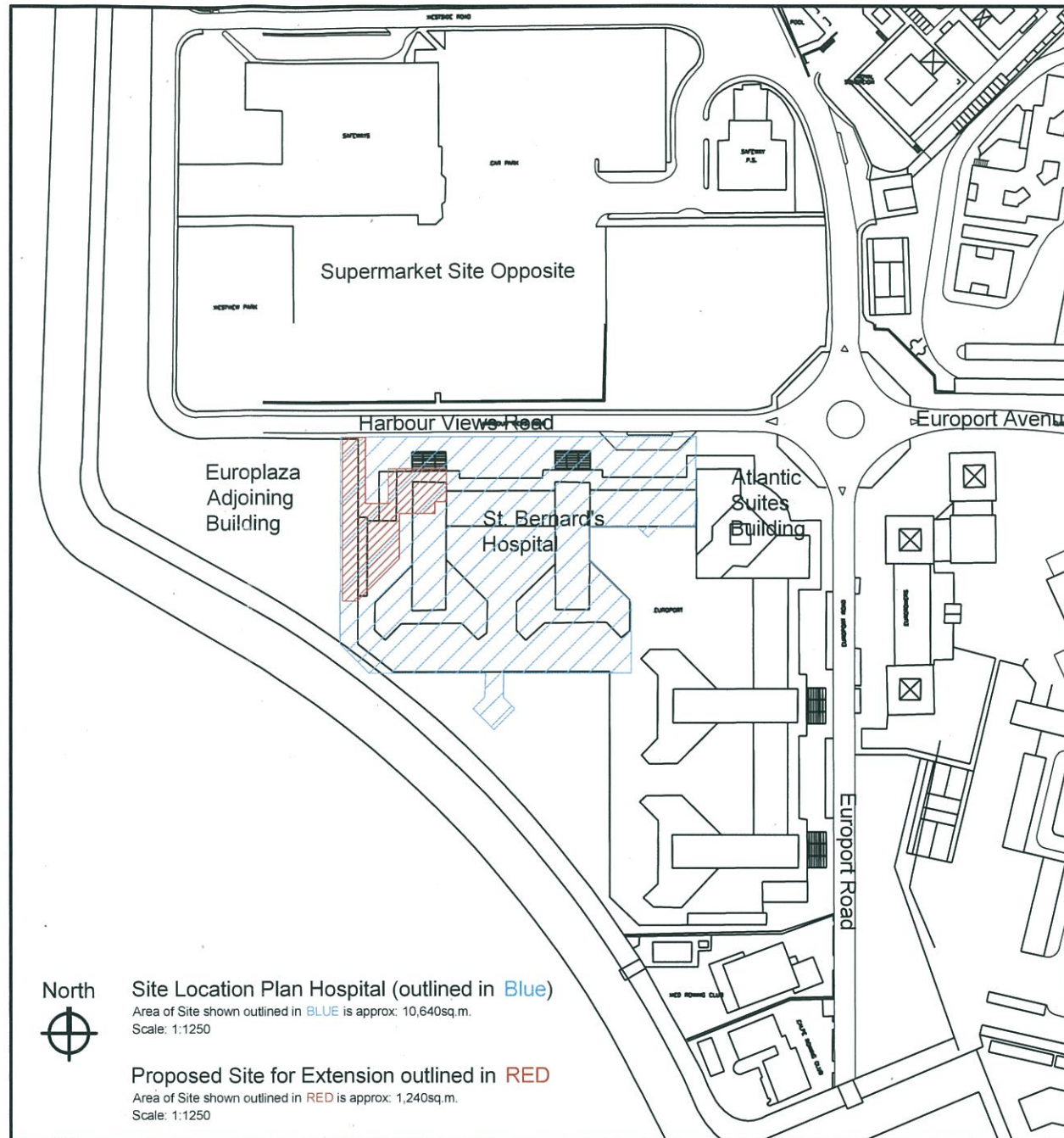

Photograph showing current Site and surrounds

Europlaza Adjoining Building

Supermarket Car Park



Site Location Plan Hospital (outlined in Blue)

Area of Site shown outlined in BLUE is approx: 10,640sq.m.
Scale: 1:1250

Proposed Site for Extension outlined in RED

Area of Site shown outlined in RED is approx: 1,240sq.m.
Scale: 1:1250

NOTES

- Drawing to be read in conjunction with the Architects Specification.
- Only selected references from the specification are shown on the drawing. Please NOTE that the CONTRACTOR is responsible for full cross referencing of the specification and drawings.
- All Dimensions shown are in millimeters and must be checked on site and NOT SCALED from these drawings. Any discrepancies must be reported to the Architect.
- ALL written dimensions to be checked on site by Contractors / Suppliers.
- ALL materials and fittings to be British Standards and Best Quality.
- ALL works to comply with the Latest Gibraltar CDM & Health and Safety regulations.
- ALL areas disturbed or exposed during works to be made good to MATCH existing adjacent.
- The CONTRACTOR is to provide samples of exact finishes and fittings to be approved prior to placement of orders and / or proceeding with the works.
- ALL arisings to be carted away and disposed of in accordance with local regulations.
- ALL columns and structural elements are indicative ONLY. Refer to Structural Engineer's drawings and specifications for all structural elements.
- FOR M&E work refer to M&E Engineer's drawings and specifications.



Location of Site
St. Bernard's Hospital
Europort
Gibraltar

North
Location Map
scale 1:50,000

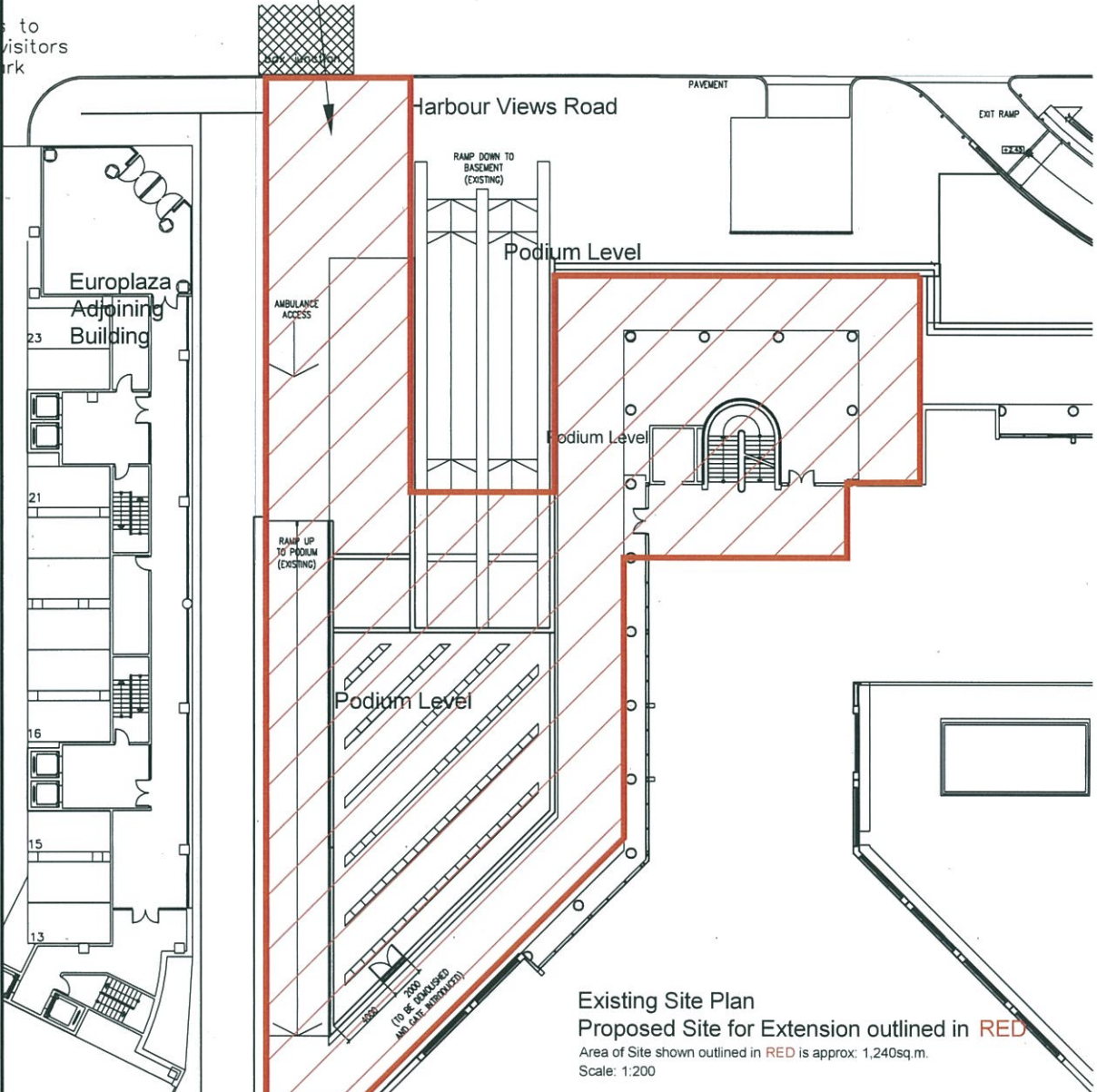

Existing Site Plan

Proposed Site for Extension outlined in RED

Area of Site shown outlined in RED is approx: 1,240sq.m.
Scale: 1:200



Photographs showing current Hospital & Proposed Site at North West corner

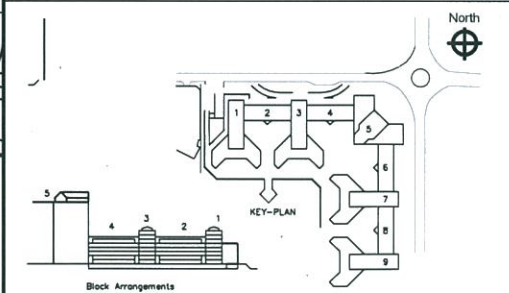

Rev.	Description	Drawn by	Date	Chkd by	Date

Gibraltar Health Authority **gha**
Gibraltar Health Authority

post St. Bernard's Hospital
Estates and technical Services
2002336
tel: JohnGerard.O'Reilly@gha.gi
email: JohnGerard.O'Reilly@gha.gi
web: www.gha.gi

project: Proposed Catering Extension
client: GHA

location: St. Bernard's Hospital

drawing: Existing Site Location Map & Plan
scale: 1:1250 & 1:200 @ A1
date: 19.08.13