

# Eco Housing North Gorge

**DESIGN SUMMARY.**  
ENERGY EFFICIENT FEATURES

**PHOTOVOLTAIC PANELS-**  
Electric Power to each apartment

**SOLAR ROOF PANELS-**  
Hot water to each apartment.

**RAINWATER HARVESTING-**  
Can satisfy approximately 53% of demand in a typical home.  
Dishwashing, Washing machine water, personal washing, drinking and food prep

**BATHROOMS.**  
Windows to all bathrooms and kitchens to provide natural ventilation.

**ROOF GARDEN.**  
With vegetable growing plots for use by residents.

**DRYING AREAS.**  
Private drying area for each apartment.

**BICYCLE GARAGES.**

**EXTERNAL WALLS.**  
High levels of wall insulation.

**WINDOWS.**  
Double glazed. Integral insulated shutters for maximum heat retention.

**WATER BOILERS.**  
Floor drains below to prevent flooding

**LIESURE**  
Park and communal leisure area.

01

02

03

04

05

06

07

08

09

10

11

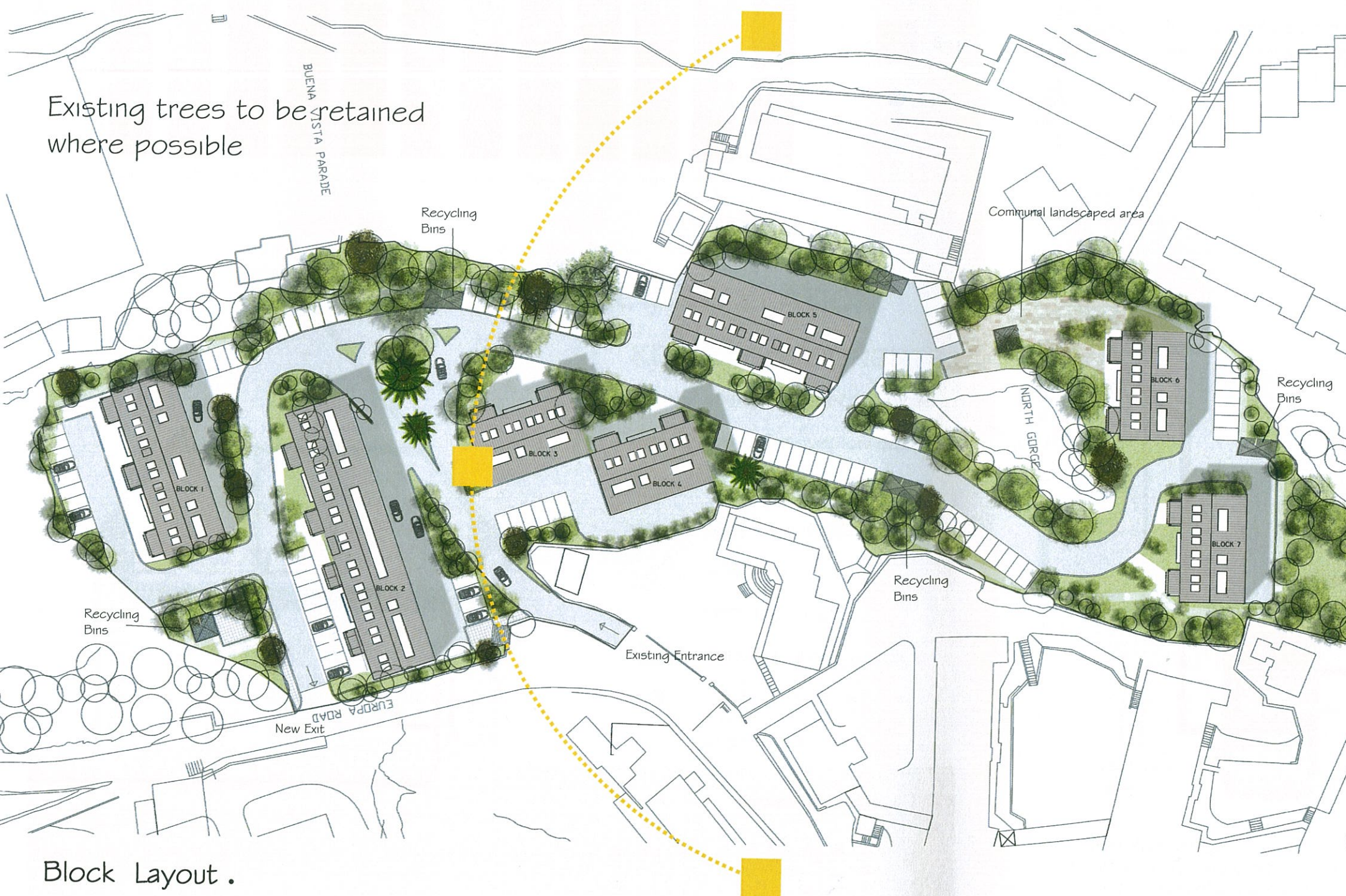

Existing trees to be retained where possible

Block Layout .