

Borders and Coastguard Agency - Headquarters

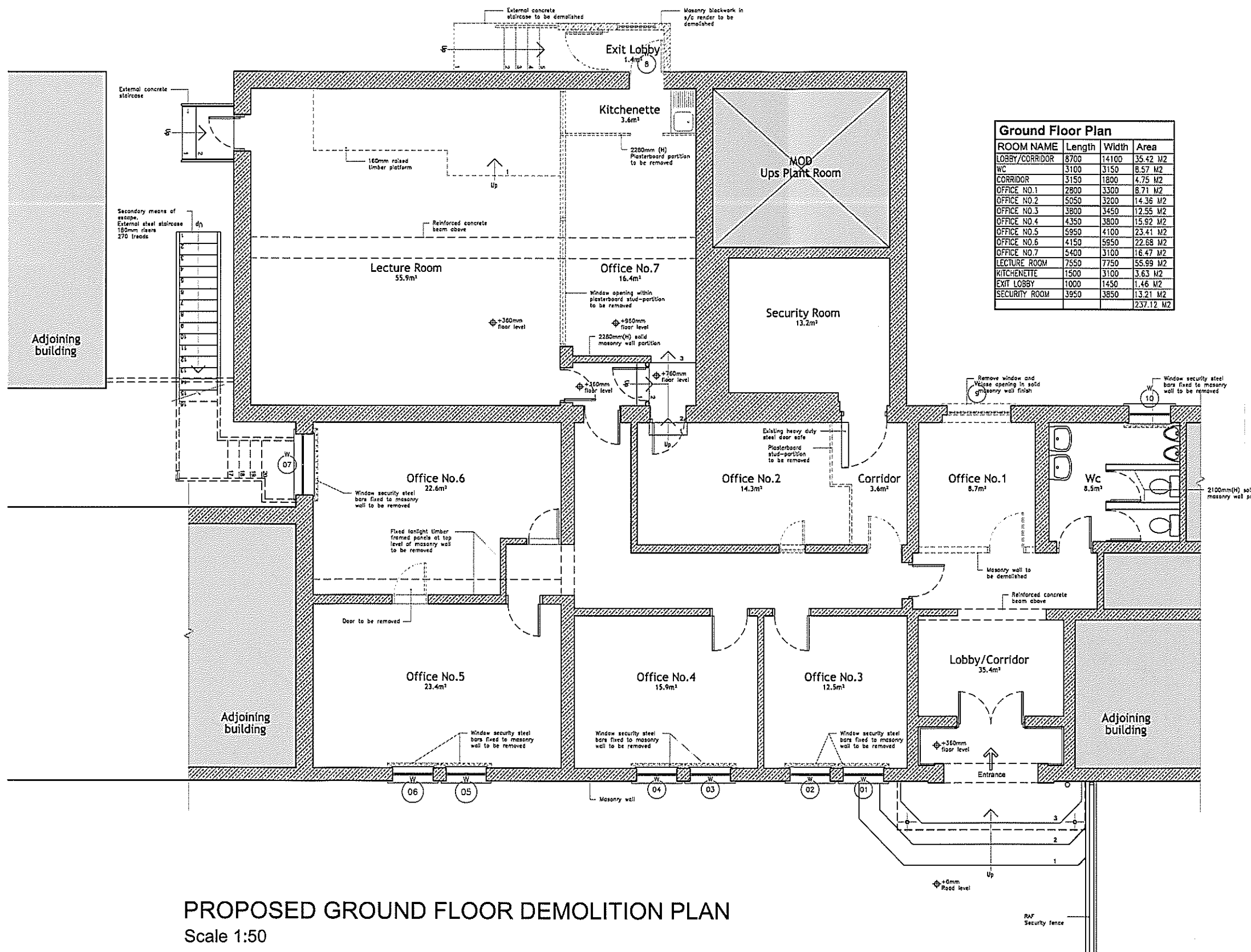

Ground Floor Plan

ROOM NAME	Length	Width	Area
LOBBY/CORRIDOR	8700	14100	35.42 M2
WC	3100	3150	8.57 M2
CORRIDOR	3150	1800	4.75 M2
OFFICE NO.1	2800	3300	8.71 M2
OFFICE NO.2	5050	3200	14.36 M2
OFFICE NO.3	3800	3450	12.55 M2
OFFICE NO.4	4350	3800	15.92 M2
OFFICE NO.5	5950	4100	23.41 M2
OFFICE NO.6	4150	5950	22.68 M2
OFFICE NO.7	5400	3100	16.47 M2
LECTURE ROOM	7550	7750	55.99 M2
KITCHENETTE	1500	3100	3.63 M2
EXIT LOBBY	1000	1450	1.46 M2
SECURITY ROOM	3950	3850	13.21 M2
			237.12 M2

- NOTES**
- GENERAL**
1. ALL DIMENSIONS GIVEN ARE IN MILLIMETRES AND MUST BE CHECKED ON SITE AND NOT SCALED FROM THESE DRAWINGS.
 2. ALL WRITTEN DIMENSIONS TO BE CHECKED ON SITE BY CONTRACTORS/SUPPLIERS.
 3. ALL MATERIALS AND FITTINGS TO BE TO BRITISH STANDARDS AND BEST QUALITY.
 4. ALL WORKS TO COMPLY WITH THE LATEST GIBRALTAR CDM AND HEALTH & SAFETY REGULATIONS.
 5. ALL AREAS DISTURBED OR EXPOSED DURING WORKS TO BE MADE GOOD TO MATCH EXISTING ADJACENT WORKS.
 6. THE CONTRACTOR IS TO PROVIDE SAMPLES OF EXACT FINISHES AND FITTINGS TO BE APPROVED PRIOR TO PLACEMENT OF ORDERS AND/OR PROCEEDING WITH THE WORKS.
 7. ALL ARISING TO BE CARTED AWAY AND DISPOSED OFF IN ACCORDANCE WITH THE LOCAL REGULATIONS.
 8. ALL COLUMNS AND STRUCTURAL ELEMENTS ARE INDICATIVE ONLY, REFER TO STRUCTURAL ENGINEER'S DRAWINGS FOR ALL STRUCTURAL ELEMENTS.
 9. FOR M&E WORK REFER TO M&E ENGINEER'S DRAWINGS AND SPECIFICATION.

Rev	Date	Revisions

© copyright
D.M.Orfila Associates
 CHARTERED ARCHITECTS
 21 Horse Barrack Lane, Suite 1, Gibraltar.
 Tel/Fax (350)2040016 E-mail: david.orfila@yahooc.co.uk
 A member of the Royal Institute of British Architects

Client
GJBS Ltd.

Job Title
Border & Coastguard Agency Headquarters

Drawing Title
Proposed Ground Floor Demolition Plan

Scale
A1-1:50 A3-1:100

Date
June 2012

Drawn by
D.M.Orfila

Drawing No.
PR94-D-006

Rev									

Status:
Design