



Tree Preservation Order
Town Planning Ordinance 1999

The Convent Garden, Tree Preservation Order (10/2002.)

The Development and Planning Commission in exercise of the powers conferred on it by s.38 of the Town Planning Ordinance hereby makes the following Order:

Citation

1. This Order may be cited as The Convent Garden, Tree Preservation Order (10/2002).

Prohibited acts in relation to trees

2. No person shall:

- (a) Cut down, top, lop or willfully destroy; or

- (b) Cause or permit the cutting down, topping, lopping or wilful destruction of,

any tree specified in the Schedule to this Order or comprised in a group of trees or in a woodland so specified, except with the consent of the authority and, where such consent is given subject to conditions, in accordance with those conditions.

Applications for consent under the Order

3. An application for consent for the cutting down, topping, lopping or uprooting of any tree in respect of which this Order is in force shall be made in writing to the Development and Planning Commission and shall:

- (a) identify the tree or trees to which it relates (by reference to a plan);

- (b) specify the work for which consent is sought; and

- (c) contain a statement of the applicant's reasons for making the application.

Application of provisions of the Town Planning Ordinance 1999

4. The following provisions of the Town Planning Ordinance 1999 relating to applications, permissions and appeals shall have effect, in relation to consents under this Order and applications for such consent, subject to the appropriate modifications to take account of the fact that the application is in respect of consent under a Tree Preservation Order and not for planning permission or a permit:

- Section 21 – Notification of owners and other persons;
- Section 22 – Grant and refusal of permits;
- Section 24 – Appeal against decision of Commission

Dated this

12

day of

February 2003

Signed



Chairman

Development and Planning Commission

SCHEDULE

SPECIFICATION OF TREES

REFERENCE ON MAP	DESCRIPTION	SITUATION
W1	An area containing Mainly evergreen exotic Trees including confers, Palms and others.	

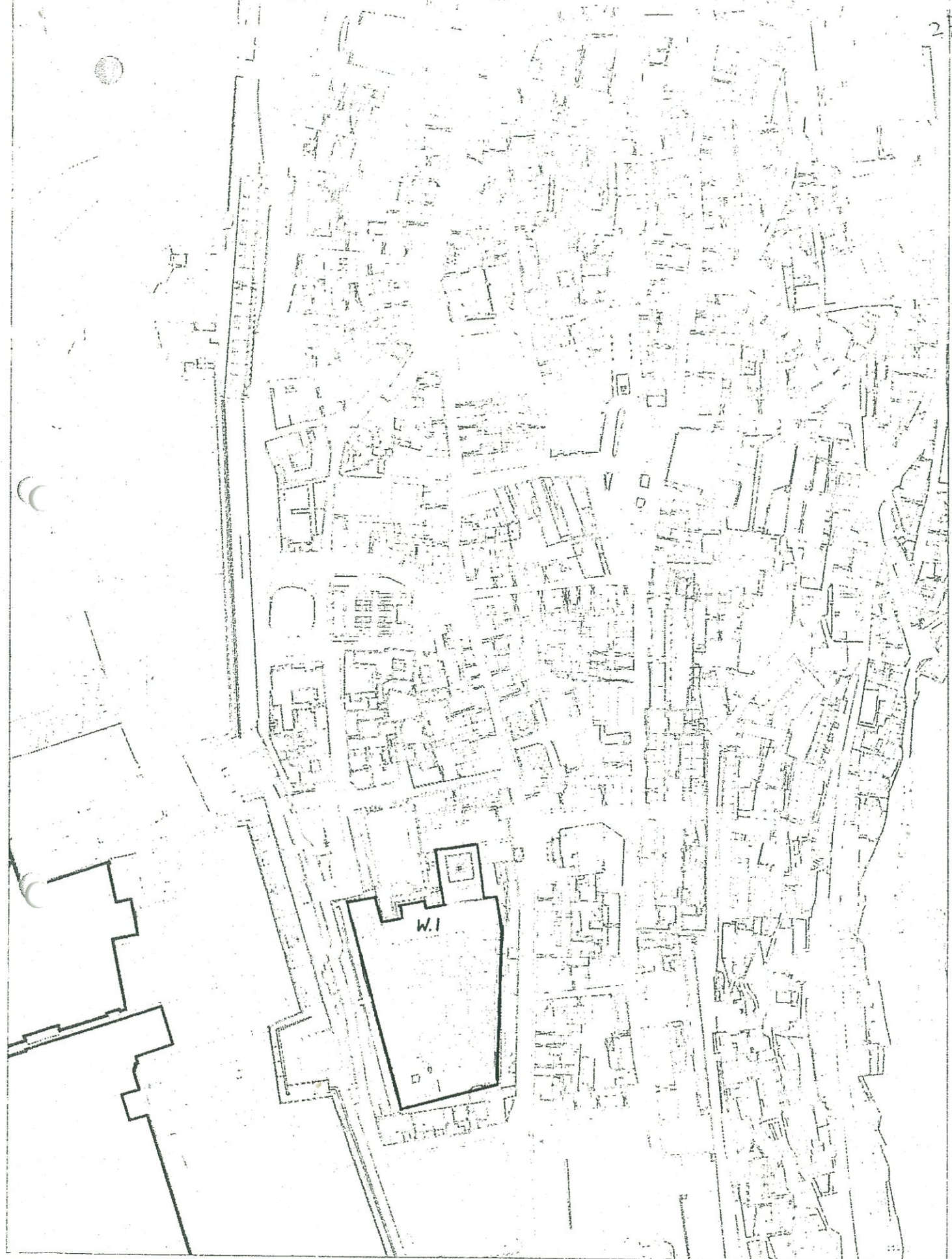

DATE: 31-05-0002
SCALE: 1:1500
NAME: Convent Gardens
REF: 10/2002

PLEASE NOTE

- 1.
- 2.
- 3.
- 4.
- 5.

TREE PRESERVATION ORDER

Planning Division
Department Trade, Industry & Telecommunications
Suite 631, Europort
Gibraltar
Phone (350) 75483
Fax (350) 74086





The Convent Gardens, Convent Place – W.1

November 2014